



FLOOR PLAN

EXHIBITION STANDS

| | |
|----|-----------|
| 1 | Exhibitor |
| 2 | Exhibitor |
| 3 | Exhibitor |
| 4 | Exhibitor |
| 5 | Exhibitor |
| 6 | Exhibitor |
| 7 | Exhibitor |
| 8 | Exhibitor |
| 9 | Exhibitor |
| 10 | Exhibitor |
| 11 | Exhibitor |
| 12 | Exhibitor |
| 13 | Exhibitor |
| 14 | Exhibitor |
| 15 | Exhibitor |
| 16 | Exhibitor |
| 17 | Exhibitor |
| 18 | Exhibitor |
| 19 | Exhibitor |
| 20 | Exhibitor |
| 21 | Exhibitor |
| 22 | Exhibitor |
| 23 | Exhibitor |

SMIME STANDS

| | |
|-----|-----------|
| S1 | Exhibitor |
| S2 | Exhibitor |
| S3 | Exhibitor |
| S4 | Exhibitor |
| S5 | Exhibitor |
| S6 | Exhibitor |
| S7 | Exhibitor |
| S8 | Exhibitor |
| S9 | Exhibitor |
| S10 | Exhibitor |
| S11 | Exhibitor |
| S12 | Exhibitor |
| S13 | Exhibitor |
| S14 | Exhibitor |
| S15 | Exhibitor |
| S16 | Exhibitor |
| S17 | Exhibitor |
| S18 | Exhibitor |

KEY

| | |
|--|-------------------------------|
| | FP&M Seta SMIME Pavilion |
| | 2x2 Stand |
| | 4x2 Stand |
| | 4x4 Stand |
| | Pillar (Marquees footing TBC) |

NOTES:

- This floor plan is subject to change without prior notice
- Pillars in stands 6, 10, 34 and 38 are available for branding opportunities

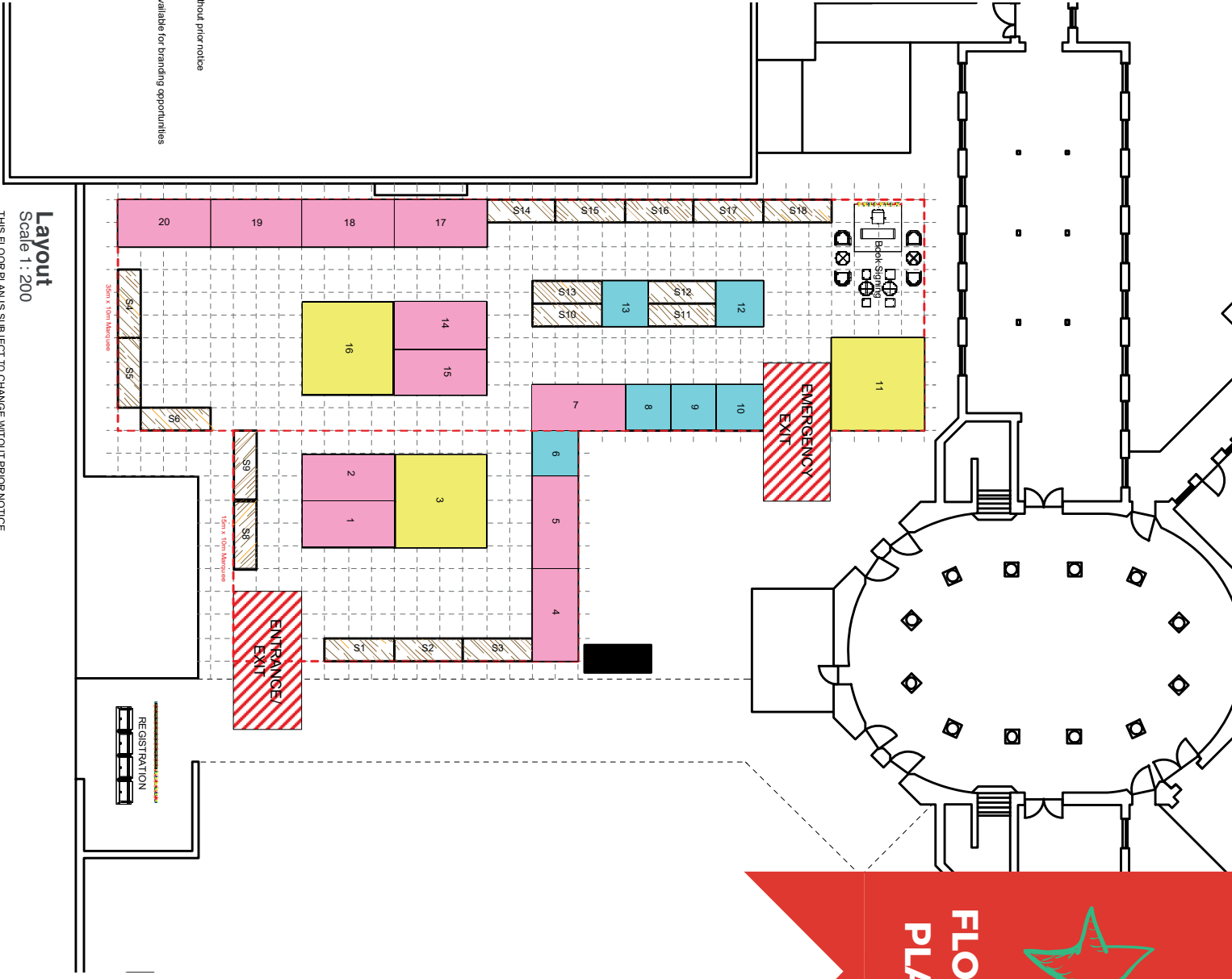

Layout

Scale 1 : 200
THIS FLOOR PLAN IS SUBJECT TO CHANGE WITHOUT PRIOR NOTICE



South African BOOK FAIR